

INSTALLATION INSTRUCTIONS

Rebar Couplers

Assembly steps

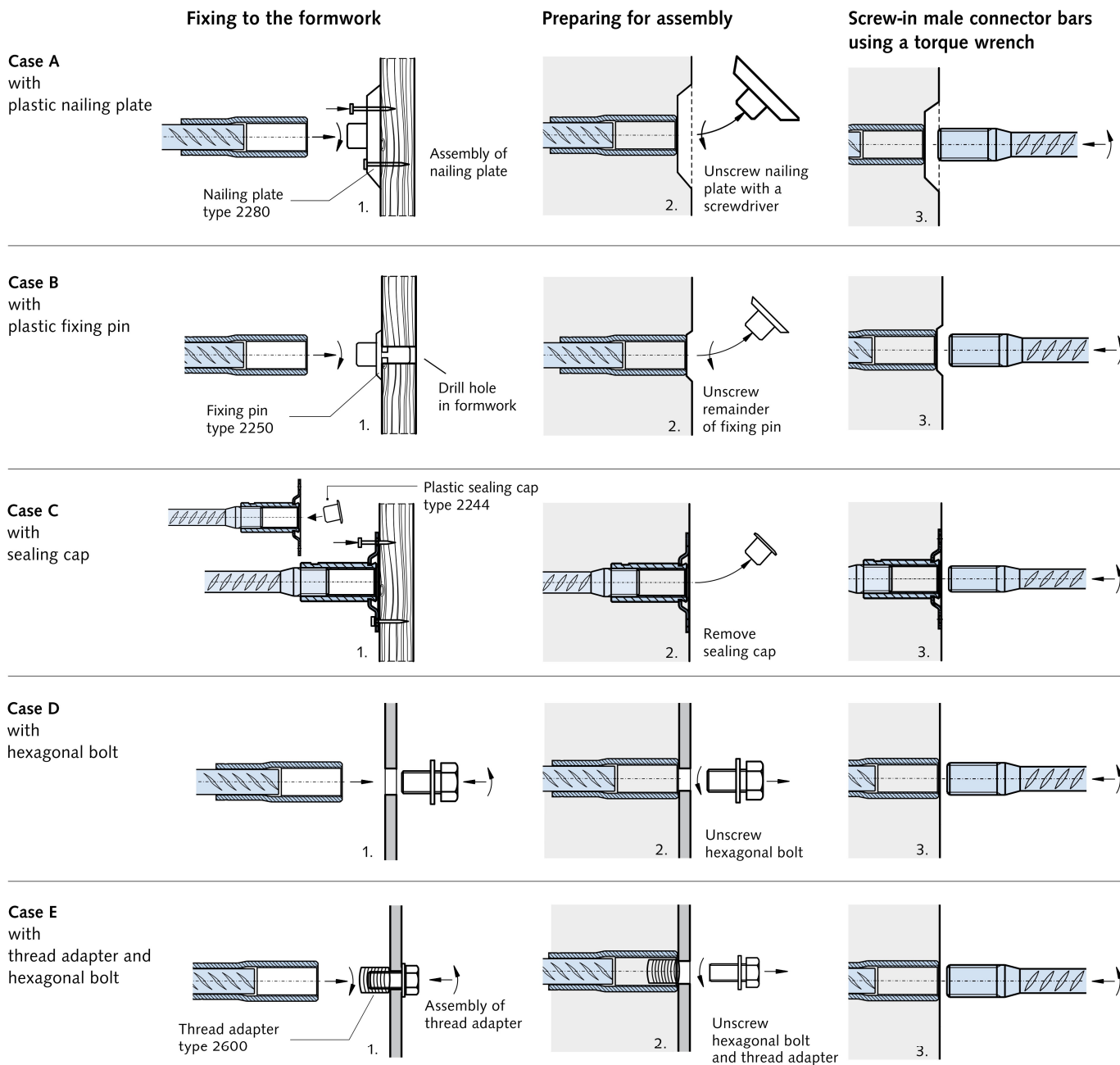

The female socket bars and male connector bars must be stored so that they remain free of dirt to ensure both can be easily connected. For further protection against ingress of dirt and concrete sludge, we also advise greasing the inside of the sleeve. Male connector bars should be tightened using a torque wrench set to the correct torque value.

Torque values

Bar diameter [mm]	12	16	20	25	32	40
Torque [Nm]	75	100	160	250	400	400

Tightening torque tolerances $\pm 5\%$